



CITY
MARKET
SOCIAL HOUSE



THIS OPEN, FREE-FLOWING LAYOUT LOCATED IN THE FASHION DISTRICT OF DOWNTOWN LA WILL BE YOUR NEXT DREAM FILMING DESTINATION!



Originally built in the 1920's, we have converted two old produce warehouses into the hippest space in DTLA boasting over 12,000 square feet of indoor space, which easily converts to outdoor pavilion. Over 3,500 square feet of private uncovered outdoor space.

- Exposed brick
- Original bow-truss ceilings
- Traditional barn-style fire door
- Floor to beam ceiling height of 15' in Studio 13
- Floor to beam ceiling height of 12' in Studio 14
- Power - (2) 200amp 3-phase company switches & (16) 20amp circuits - duplex
- High-speed dedicated Fiber Internet with redundant connection
- HVAC (64-tons)
- New, Well Appointed ADA Restrooms (17)
- Green Rooms & Coordinating Offices
- (3) Loading Docks directly into Studio 14
- Built-In Bar
- 2,700 s.f. Studio Kitchen with 20' ceilings and lofted viewing portals
- Convenient vehicle display access in Studios
- Comprehensive COVID safety plan



STUDIO 14
8,934 square feet
12ft floor to beam height



STUDIO 13
2,237 square feet
15ft floor to beam height

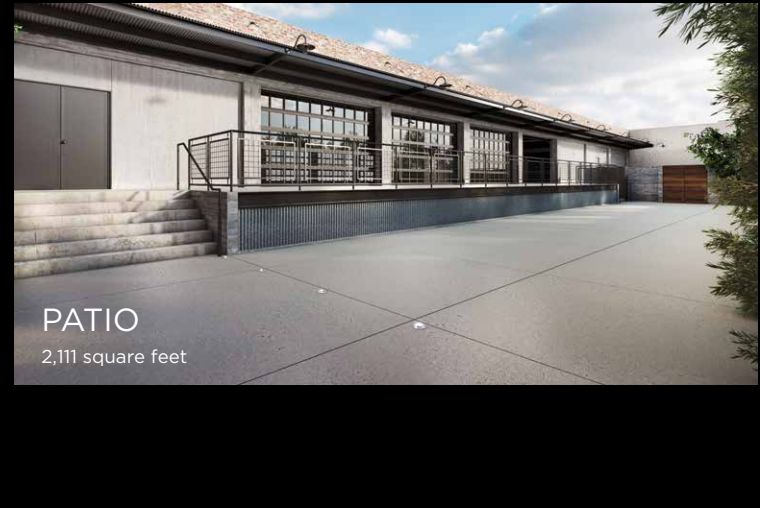
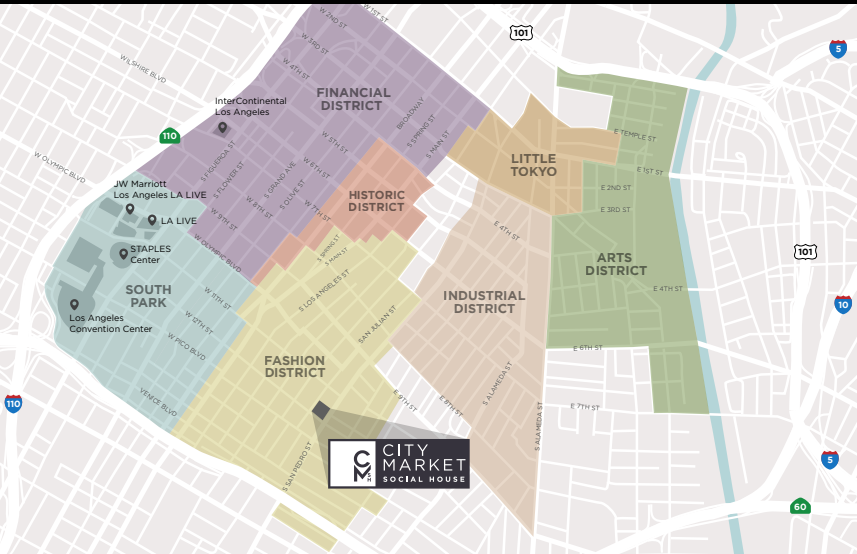

PATIO
2,111 square feet

Located within 1-2 miles of the venue

- Smart and Final
- Home Depot
- Moskatels
- Whole Foods
- Ralphs
- Jason's Liquor

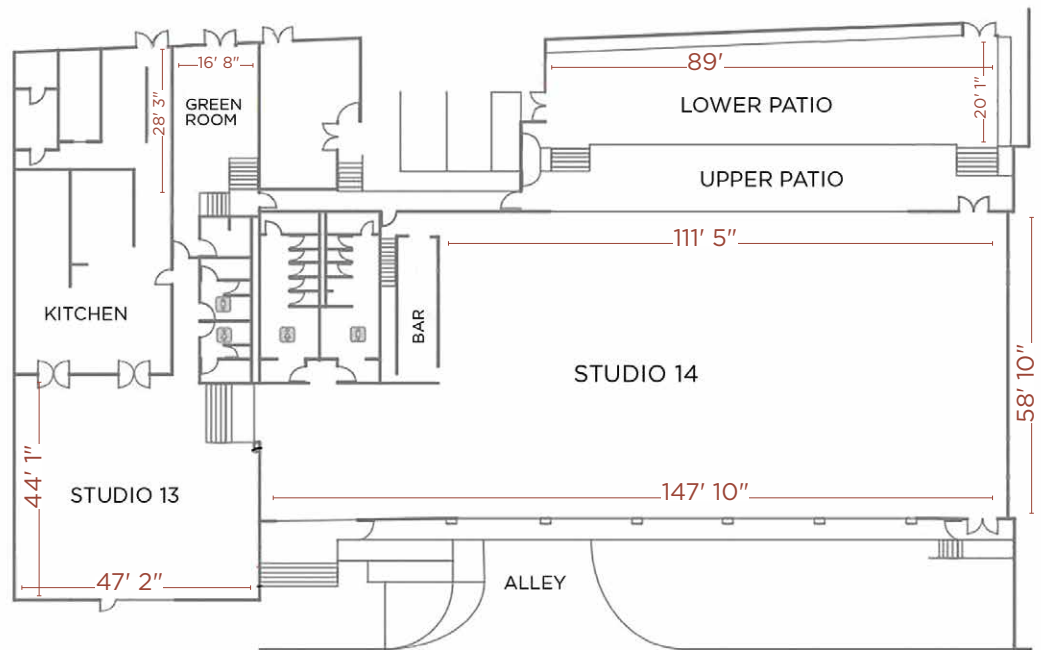

NOW AVAILABLE FOR SHORT AND LONG TERM FILMING ENGAGEMENTS!

EVENTS@CITYMARKETSOCIALHOUSE.COM | 844.310.2674

1145 SOUTH SAN PEDRO STREET LOS ANGELES, CA 90015

@CITYMARKETSOCIALHOUSE